



# STRIP LED

ALIMENTATORI  
DA ORDINARE A PARTE, VEDI PAG. 33  
DRIVERS  
TO BE ORDERED SEPARATELY, SEE P. 33

SISTEMI DI CONTROLLO  
DA ORDINARE A PARTE, VEDI PAG. 34-39  
CONTROL SYSTEMS  
TO BE ORDERED SEPARATELY, SEE P. 34-39

## STRIP LED HIGH FLUX IP20 21W/m CRI 80

**STRIP LED IP20 21W/M CRI 80 FLESSIBILE** bobina da 5m; da abbinare obbligatoriamente a profiled kit; alimentatore 24Vdc da ordinare a parte.

**STRIP LED IP20 21W/M CRI 80 FLEXIBLE** 5m reel; mandatory to match with profiled kit; 24Vdc driver to be ordered separately.

### 3000K

Codice/Code	W led/m	Vdc	Led/m	Lm/m	CRI
102107.99	21	24	112	3254	>80

### 4000K

Codice/Code	W led/m	Vdc	Led/m	Lm/m	CRI
102108.99	21	24	112	3320	>80



## STRIP LED IP20 14,4W/m CRI 90

**STRIP LED IP20 14,4W/M CRI 90 FLESSIBILE** bobina da 5m; da abbinare obbligatoriamente a Profiled kit; alimentatore 24Vdc da ordinare a parte

**STRIP LED IP20 14,4W/M CRI 90 FLEXIBLE** 5m reel; mandatory to match with Profiled kit; 24Vdc driver to be ordered separately

### 2700K

Codice/Code	W led/m	Vdc	Led/m	Lm/m	CRI
102205.99	14,4	24	60	1056	>90

### 3000K

Codice/Code	W led/m	Vdc	Led/m	Lm/m	CRI
102201.99	14,4	24	60	1132	>90

### 4000K

Codice/Code	W led/m	Vdc	Led/m	Lm/m	CRI
102202.99	14,4	24	60	1165	>90

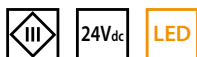

## STRIP LED IP20 19,2W/m CRI 90

**STRIP LED IP20 19,2W/M CRI 90 FLESSIBILE** bobina da 5m; da abbinare obbligatoriamente a Profiled kit; alimentatore 24Vdc da ordinare a parte

**STRIP LED IP20 19,2W/M CRI 90 FLEXIBLE** 5m reel; mandatory to match with Profiled kit; 24Vdc driver to be ordered separately

### 2700K

Codice/Code	W led/m	Vdc	Led/m	Lm/m	CRI
102105.99	19,2	24	240	1463	>90

### 3000K

Codice/Code	W led/m	Vdc	Led/m	Lm/m	CRI
102101.99	19,2	24	240	1546	>90

### 4000K

Codice/Code	W led/m	Vdc	Led/m	Lm/m	CRI
102102.99	19,2	24	240	1594	>90

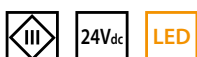

SMD 5630 (112led/m)



Biadesivo - sezionabile ogni 71,5mm (8 LED)  
Biadhesive - cuttable every 71,5mm (8 LED)



SMD 5050 (60led/m)

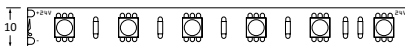

Biadesivo - sezionabile ogni 100mm (6 LED)  
Biadhesive - cuttable every 100mm (6 LED)



SMD 3528 (240 led/m)

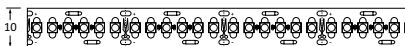

Biadesivo - sezionabile ogni 25mm (6 LED)  
Biadhesive - cuttable every 25mm (6 LED)



SMD 5050 (60 led/m)

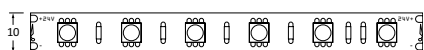

Biadesivo - sezionabile ogni 100mm (6 LED)  
Biadhesive - cuttable every 100mm (6 LED)



SMD 5050 (60 led/m)



Biadesivo - sezionabile ogni 100mm (6 LED)  
Biadhesive - cuttable every 100mm (6 LED)



SMD 5050 (60 led/m)

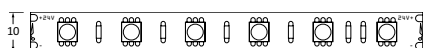

Biadesivo - sezionabile ogni 100mm (6 LED)  
Biadhesive - cuttable every 100mm (6 LED)



SMD 5050 (60 led/m)

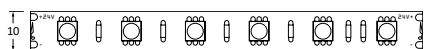

Biadesivo - sezionabile ogni 100mm (6 LED)  
Biadhesive - cuttable every 100mm (6 LED)

## STRIP LED PERFORMANCE IP20 14,4W/m CRI 80

**STRIP LED PERFORMANCE IP20 14,4W/M CRI 80 FLESSIBILE** bobina da 5m; da abbinare obbligatoriamente a Profiled kit; alimentatore 24Vdc da ordinare a parte.

**STRIP LED PERFORMANCE IP20 14,4W/M CRI 80 FLEXIBLE** 5m reel; mandatory to match with Profiled kit; 24Vdc driver to be ordered separately.

### 3000K

Codice/Code	W led/m	Vdc	Led/m	Lm/m	CRI
<b>102601.99</b>	14,4	24	60	1350	>80

### 4000K

Codice/Code	W led/m	Vdc	Led/m	Lm/m	CRI
<b>102602.99</b>	14,4	24	60	1391	>80



## STRIP LED PERFORMANCE IP65 14,4W/m CRI 80

**STRIP LED PERFORMANCE IP65 14,4W/M CRI 80 FLESSIBILE** bobina da 5m; da abbinare obbligatoriamente a Profiled kit; alimentatore 24Vdc da ordinare a parte.

**STRIP LED PERFORMANCE IP65 14,4W/M CRI 80 FLEXIBLE** 5m reel; mandatory to match with Profiled kit; 24Vdc driver to be ordered separately.

### 3000K

Codice/Code	W led/m	Vdc	Led/m	Lm/m	CRI
<b>102603.99</b>	14,4	24	60	1350	>80

### 4000K

Codice/Code	W led/m	Vdc	Led/m	Lm/m	CRI
<b>102604.99</b>	14,4	24	60	1391	>80



## STRIP LED PERFORMANCE IP20 16,5W/m

**STRIP LED PERFORMANCE IP20 16,5W/M FLESSIBILE** bobina da 5m; da abbinare obbligatoriamente a Profiled kit; alimentatore 24Vdc da ordinare a parte.

**STRIP LED PERFORMANCE IP20 16,5W/M FLEXIBLE** 5m reel; mandatory to match with Profiled kit; 24Vdc driver to be ordered separately.

### 3000K

Codice/Code	W led/m	Vdc	Led/m	Lm/m
<b>100901.99</b>	16,5	24	60	1400

### 4000K

Codice/Code	W led/m	Vdc	Led/m	Lm/m
<b>100902.99</b>	16,5	24	60	1450



## STRIP LED PERFORMANCE IP65 16,5W/m

**STRIP LED PERFORMANCE IP65 16,5W/M FLESSIBILE** bobina da 5m; da abbinare obbligatoriamente a Profiled kit; alimentatore 24Vdc da ordinare a parte.

**STRIP LED PERFORMANCE IP65 16,5W/M FLEXIBLE** 5m reel; mandatory to match with Profiled kit; 24Vdc driver to be ordered separately.

### 3000K

Codice/Code	W led/m	Vdc	Led/m	Lm/m
<b>100905.99</b>	16,5	24	60	1400

### 4000K

Codice/Code	W led/m	Vdc	Led/m	Lm/m
<b>100906.99</b>	16,5	24	60	1450



## STRIP LED PERFORMANCE IP20 19,2W/m CRI 80

**STRIP LED PERFORMANCE IP20 19,2W/M CRI 80 FLESSIBILE** bobina da 5m; da abbinare obbligatoriamente a Profiled kit; alimentatore 24Vdc da ordinare a parte.

**STRIP LED PERFORMANCE IP20 19,2W/M CRI 80 FLEXIBLE** 5m reel; mandatory to match with Profiled kit; 24Vdc driver to be ordered separately.

### 3000K

Codice/Code	W led/m	Vdc	Led/m	Lm/m	CRI
<b>102501.99</b>	19,2	24	240	1752	>80

### 4000K

Codice/Code	W led/m	Vdc	Led/m	Lm/m	CRI
<b>102502.99</b>	19,2	24	240	1807	>80

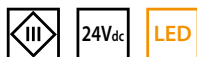

## STRIP LED PERFORMANCE IP65 19,2W/m CRI 80

**STRIP LED PERFORMANCE IP65 19,2W/M CRI 80 FLESSIBILE** bobina da 5m; da abbinare obbligatoriamente a Profiled kit; alimentatore 24Vdc da ordinare a parte.

**STRIP LED PERFORMANCE IP65 19,2W/M CRI 80 FLEXIBLE** 5m reel; mandatory to match with Profiled kit; 24Vdc driver to be ordered separately.

### 3000K

Codice/Code	W led/m	Vdc	Led/m	Lm/m	CRI
<b>102503.99</b>	19,2	24	240	1752	>80

### 4000K

Codice/Code	W led/m	Vdc	Led/m	Lm/m	CRI
<b>102504.99</b>	19,2	24	240	1807	>80



## STRIP LED PERFORMANCE IP20 22W/m

**STRIP LED PERFORMANCE IP20 22W/M FLESSIBILE** bobina da 5m; da abbinare obbligatoriamente a profiled kit; alimentatore 24Vdc da ordinare a parte.

**PERFORMANCE STRIP LED IP20 22W/M FLEXIBLE** 5m reel; mandatory to match with profiled kit; 24Vdc driver to be ordered separately.

### 3000K

Codice/Code	W led/m	Vdc	Led/m	Lm/m	CRI
<b>100903.99</b>	22	24	240	1700	>80

### 4000K

Codice/Code	W led/m	Vdc	Led/m	Lm/m	CRI
<b>100904.99</b>	22	24	240	1750	>80



## STRIP LED PERFORMANCE IP65 22W/m

**STRIP LED PERFORMANCE IP65 22W/M FLESSIBILE** bobina da 5m; da abbinare obbligatoriamente a profiled kit; alimentatore 24Vdc da ordinare a parte.

**STRIP LED PERFORMANCE IP65 22W/M FLEXIBLE** 5m reel; mandatory to match with profiled kit; 24Vdc driver to be ordered separately.

### 3000K

Codice/Code	W led/m	Vdc	Led/m	Lm/m	CRI
<b>100907.99</b>	22	24	240	1700	>80

### 4000K

Codice/Code	W led/m	Vdc	Led/m	Lm/m	CRI
<b>100908.99</b>	22	24	240	1750	>80



SMD 3528 (240 led/m)

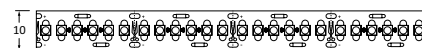

Biadesivo - sezionabile ogni 25mm (6 LED)  
Biadhesive - cuttable every 25mm (6 LED)



SMD 3528 (240 led/m)

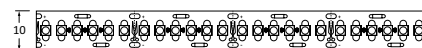

Biadesivo - sezionabile ogni 25mm (6 LED)  
Biadhesive - cuttable every 25mm (6 LED)



SMD 3528 (240 led/m)

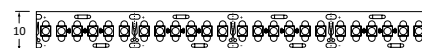

Biadesivo - sezionabile ogni 25mm (6 LED)  
Biadhesive - cuttable every 25mm (6 LED)



SMD 3528 (240 led/m)



Biadesivo - sezionabile ogni 25mm (6 LED)  
Biadhesive - cuttable every 25mm (6 LED)



SMD 5050 (60 led/m)

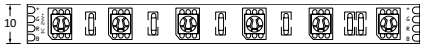

Biadesivo - sezionabile ogni 100mm (6 LED)  
Biadhesive - cuttable every 100mm (6 LED)

## STRIP LED IP20 RGB

**STRIP LED IP20 FLESSIBILE FULL COLOR RGB** bobina da 5m; da abbinare obbligatoriamente a Profiled kit; alimentatore 24Vdc da ordinare a parte.

**STRIP LED IP20 FLEXIBLE FULL COLOR RGB** 5m reel; mandatory to match with Profiled kit; 24Vdc driver to be ordered separately.

Codice/Code	W led/m	Vdc	Led/m
<b>102605.99</b>	14,4	24	60



SMD 5050 (60 led/m)



Biadesivo - sezionabile ogni 100mm (6 LED)  
Biadhesive - cuttable every 100mm (6 LED)

## STRIP LED IP65 RGB

**STRIP LED IP65 FLESSIBILE FULL COLOR RGB** bobina da 5m; da abbinare obbligatoriamente a Profiled kit; alimentatore 24Vdc da ordinare a parte.

**STRIP LED IP65 FLEXIBLE FULL COLOR RGB** 5m reel; mandatory to match with Profiled kit; 24Vdc driver to be ordered separately.

Codice/Code	W led/m	Vdc	Led/m
<b>102606.99</b>	14,4	24	60



SMD 5050 (60 led/m)



Biadesivo - sezionabile ogni 167mm  
Biadhesive - cuttable every 167mm

## STRIP LED IP20 RGB+WHITE

**STRIP LED IP20 RGB+WHITE FLESSIBILE** bobina da 5m; da abbinare obbligatoriamente a Profiled kit; alimentatore 24Vdc da ordinare a parte.

**STRIP LED IP20 RGB+WHITE FLEXIBLE FULL** 5m reel; mandatory to match with Profiled kit; 24Vdc driver to be ordered separately.

Codice/Code	W led/m	Vdc	Led/m	Lm/m
<b>102607.99</b>	7,2 (RGB) / 7,2 (WHITE)	24	60	180 (RGB) / 540 (WHITE)



# ALIMENTATORI STRIP LED / STRIP LED DRIVERS

## ALIMENTATORE ELETTRONICO STABILIZZATO 24 VDC PER STRIP LED WHITE, RGB E RGB+W 220-240V 50/60Hz

ELECTRONIC STABILIZED DRIVER 24VDC FOR BOTH STRIP LED WHITE, RGB OR RGB+W 220-240V 50/60Hz

Codice/Code	W	L (mm)	A (mm)	H (mm)	D (mm)
<b>18601.99</b>	50	110	78	35	86
<b>18602.99</b>	75	130	98	40	106
<b>18603.99</b>	100	130	98	40	106
<b>18604.99</b>	150	160	98	42	107
* <b>E182K1240KK</b>	240	190	93	50	106
* <b>E182K1320KK</b>	320	215	115	50	126

\* Alimentatori con dissipazione attiva, completi di ventola. Non installare in ambienti in cui è richiesto il massimo silenzio. Posizionare in vano adeguatamente areato.

\* Active power dissipation, complete with fan. Do not install in environments that require complete silence. Place in well-ventilated compartment.

24V<sub>dc</sub>

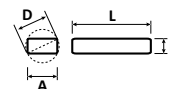
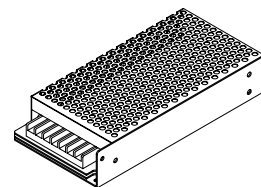

## ALIMENTATORE ELETTRONICO STABILIZZATO 24 VDC 220-240V 50/60Hz

ELECTRONIC STABILIZED DRIVER 24 VDC 220-240V 50/60Hz

Codice/Code	W	L (mm)	A (mm)	H (mm)	D (mm)
<b>101301.99</b>	45	251	30	16	34
<b>101302.99</b>	100	320	30	18	35

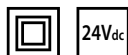
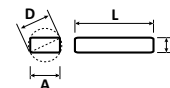
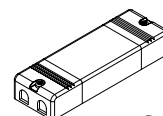

24V<sub>dc</sub>

## ALIMENTATORE ELETTRONICO STABILIZZATO 24 VDC 220-240V 50/60Hz

ELECTRONIC STABILIZED DRIVER 24 VDC

Codice/Code	W	L (mm)	A (mm)	H (mm)	D (mm)
* <b>E182K0060KK</b>	60	163	43	32	54
* <b>E182K0100KK</b>	100	190	52	37	64
<b>18606.99</b>	250	226	73	38	83
<b>18607.99</b>	320	246	84	42	94

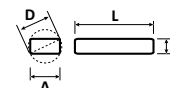
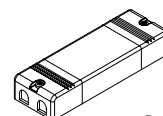

\*

## ALIMENTATORE ELETTRONICO DIMMERABILE STABILIZZATO 24 Vdc 220-240V 50/60Hz

ELECTRONIC STABILIZED DIMMABLE DRIVER 24 Vdc 220-240V 50/60Hz

Codice/Code	W	L (mm)	A (mm)	H (mm)	D (mm)	
* <b>A902K0010KK</b>	20	103	67	21	72	1-10V/PUSH
<b>A901K0029KK</b>	75	220	47	44	65	DALI/PUSH
* <b>A902K0018KK</b>	100	240	60	48	78	1-10V/PUSH

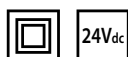
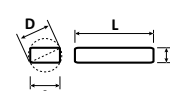
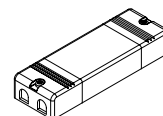

\*

CAVETTO DI SINCRONIZZAZIONE PER ARTICOLO A902K0018KK Indispensabile per la sincronizzazione di due o più alimentatori (max. 10) comandati da uno o più pulsanti NA in parallelo

SYNCHRONIZATION CABLE FOR CODE A902K0018KK Mandatory for the synchronization of two or more drivers (max. 10) managed by one or more NO switches in parallel

Codice/Code	L (mm)
<b>A902K0019KK</b>	2000

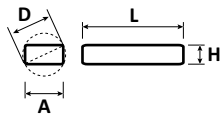
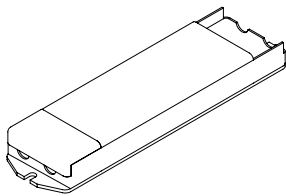

**INTERFACCIA DI DIMERAZIONE** per Strip LED WHITE 24 Vdc  
DALI/1-10V/0-10V/PUSH; alimentatore 24Vdc da ordinare a parte, massimo carico 12Ax1 canale

**INTERFACE FOR DIMMING** Strip LED WHITE 24 Vdc  
DALI/1-10V/0-10V/PUSH; driver 24Vdc to be ordered separately; maximum load 12Ax1CH

Codice/Code	L (mm)	A (mm)	H (mm)	D (mm)
<b>18001.99</b>	155	51	26	58

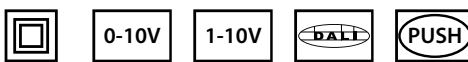

STRIP LED WHITE	N° bobine per Interfaccia da collegare in parallelo Nos. reels for each Interface to be connected in parallel	Potenza Alimentatori Drivers Power W	STRIP LED WHITE	N° bobine per Interfaccia da collegare in parallelo Nos. reels for each Interface to be connected in parallel	Potenza Alimentatori Drivers Power W
14,4W/m	4	320	19,2W/m	3	320
14,4W/m	3	240/250	19,2W/m	2	240/250
14,4W/m	2	150	19,2W/m	1	100
14,4W/m	1	100			
16,5W/m	3	320	21W/m - 22W/m	2	320
16,5W/m	2	240/250	21W/m - 22W/m	1	150
16,5W/m	1	100			

SCHEMA DI COLLEGAMENTO DALI  
WIRING DIAGRAM DALI

SCHEMA DI COLLEGAMENTO PUSH  
WIRING DIAGRAM PUSH

SCHEMA DI COLLEGAMENTO 1...10V, 0...10V  
WIRING DIAGRAM 1...10V, 0...10V

SCHEMA DI COLLEGAMENTO MASTER/SLAVE  
WIRING DIAGRAM MASTER/SLAVE

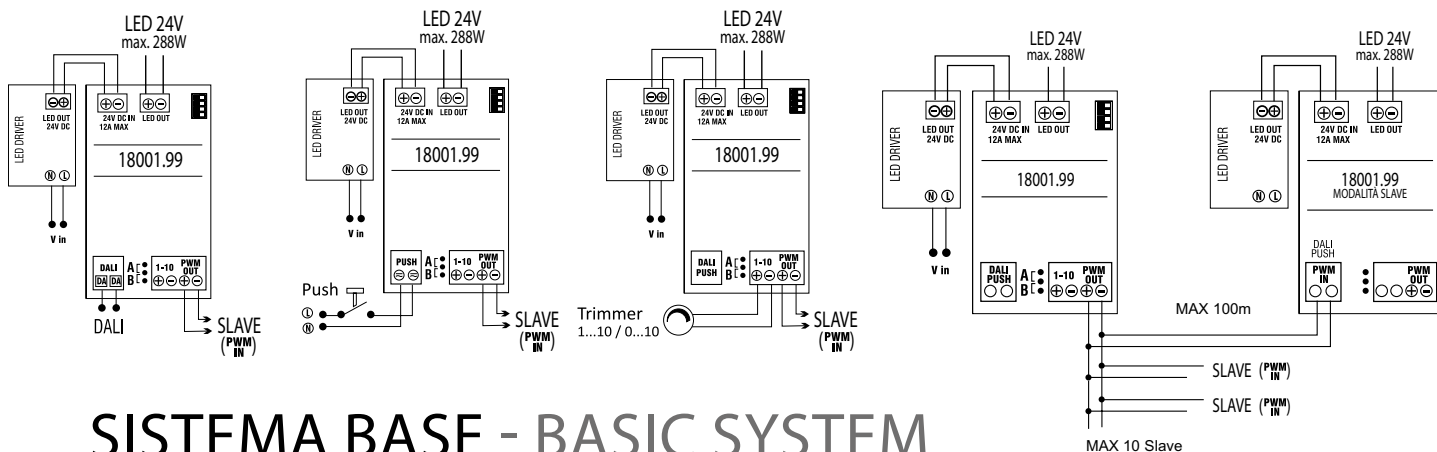

## SISTEMA BASE - BASIC SYSTEM

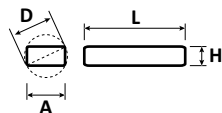
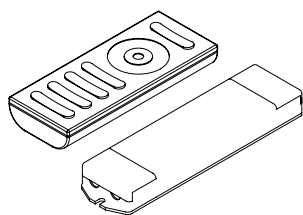

**KIT DI CONTROLLO PER STRIP LED RGB** completo di attuatore e telecomando. Non collegabili attuatori in cascata. Alimentatore 24Vdc da ordinare a parte.

**CONTROL KIT FOR RGB STRIP LED** with controller and remote included. Not connectable controllers in cascade. Driver 24Vdc to be ordered separately.

Codice/Code	L (mm)	A (mm)	H (mm)	D (mm)
<b>16901.99</b>	145	47	17	50

STRIP LED RGB

N° bobine per Interfaccia da collegare in parallelo  
Nos. reels for each Interface to be connected in parallel

Potenza Alimentatori Drivers Power  
W

14,4W/m	4	320
	3	240/250
	2	150
	1	100

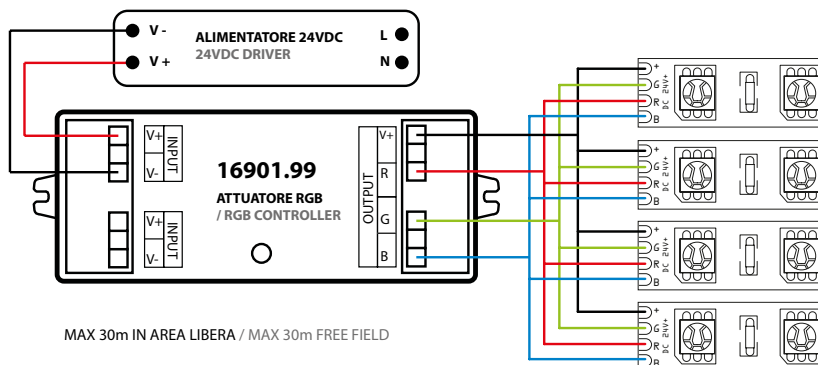



# SISTEMA AVANZATO - ADVANCED SYSTEM

**ATTUATORE DI CONTROLLO PER STRIP LED WHITE, RGB E RGB+W** alimentatore 24Vdc, dispositivi di controllo (telecomando, controllo da parete od eventuale trasmettitore WiFi) da ordinare a parte.

**CONTROLLER FOR STRIP LED WHITE, RGB AND RGB+W DRIVER** 24Vdc, control units (remote, wall-mounted or WiFi transmitter) to be ordered separately.

Codice/Code	L (mm)	A (mm)	H (mm)	D (mm)
<b>16905.99</b>	178	46	22	65

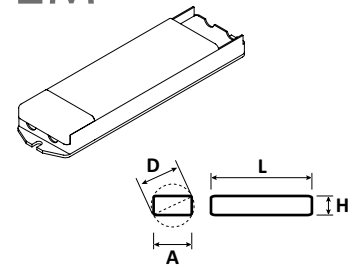

**TELECOMANDO PER STRIP LED WHITE** attuatore 16905.99 ed alimentatore 24Vdc da ordinare a parte. Controllo dell'intensità luminosa mediante pad capacitivo, pulsanti dedicati per portare velocemente l'intensità alla percentuale indicata (25%, 50%, 75%, 100%). Ogni telecomando può gestire fino ad un massimo di 4 gruppi e per ogni gruppo fino a 3 diverse scene, utilizzando i pulsanti corrispondenti (S1, S2 e S3). Necessita di 3 pile AAA.

**REMOTE FOR MANAGING WHITE STRIP LED** controller 16905.99 and driver 24Vdc to be ordered separately. Control of luminous intensity through a capacity pad, buttons dedicated for rapid increase of intensity to the selected parameter (25%, 50%, 75%, 100%). Each remote can manage up to a max. of 4 groups and up to 3 scenarios per each group by using the corresponding buttons (S1, S2 and S3). 3 AAA batteries are required.



Codice/Code

**16906.99**

**TELECOMANDO PER STRIP LED RGB ED RGB+W** attuatore 16905.99 ed alimentatore 24Vdc da ordinare a parte.

Controllo del colore mediante pad capacitivo, controllo della luminosità mediante pulsanti dedicati, possibilità di selezionare 10 show di transizione colore e sequenze colori differenti pre-caricati, oltre alla regolazione della velocità. Ogni telecomando può gestire fino ad un massimo di 4 gruppi e per ogni gruppo fino a 3 colori o 3 diverse scene utilizzando i pulsanti corrispondenti (S1, S2 e S3). Pulsante di richiamo rapido del colore bianco caldo, neutral e freddo. Necessita di 3 pile AAA.

**REMOTE FOR MANAGING STRIP LED RGB AND RGB+W** controller 16905.99 and driver 24Vdc to be ordered separately. Colour control through a capacity pad, control of luminous intensity through dedicated buttons, possibility to select 10 colour changing scenarios and sequences among those pre-uploaded, additionally to speed regulation. Each remote can manage up to max. 4 groups and up to 3 colours or 3 different scenarios per each group by using the corresponding buttons (S1, S2 and S3). Quick recall button for cold white, neutral white and warm white. 3 AAA buttons are required.



Codice/Code

**16902.99**

**CONTROLLO DA PARETE PER STRIP LED RGB ED RGB+W** da installare in scatola 502 (non inclusa). Attuatore 16905.99 ed alimentatore 24Vdc da ordinare a parte.

Controllo del colore mediante pad capacitivo, controllo della luminosità mediante pulsanti dedicati, possibilità di selezionare 10 show di transizione colore e sequenze colori differenti pre-caricati, oltre alla regolazione della velocità.

Ogni controllo può gestire fino a un massimo di 4 gruppi e per ogni gruppo fino a 4 colori o 4 diverse scene. Alimentazione del controllo da parete 220-240V 50/60Hz.

**WALL- MOUNTED CONTROL UNIT FOR STRIP LED RGB AND RGB+W LED** to be installed in 502 box ( not included). Controllers 16905.99 and driver 24Vdc to be ordered separately.

Control of colour through a capacity pad, control of luminous intensity through dedicated buttons, possibility to select 10 scenarios of colour changing and sequences among those pre-uploaded, additionally to speed regulation.

Each remote can manage up to max 4 groups and up to 4 colours and 4 different scenarios per each group. Power for wall mounted control at 220-240V 50/60Hz.

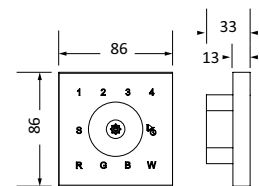
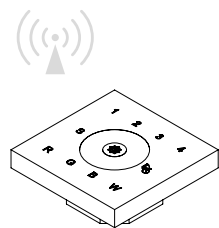

Codice/Code

**16903.99**

**TRASMETTITORE WIFI INTERFACCIABILE CON DISPOSITIVI ANDROID E IOS.** Attuatore 16905.99 ed alimentatore 24Vdc da ordinare a parte. Tutte le funzioni di controllo possono essere gestite dall'App scaricabile dal market (tramite App si possono gestire fino ad un massimo di 8 gruppi). Nel dimensionamento della potenza dell'alimentatore, considerare 10W di potenza per l'alimentazione del trasmettitore WiFi.

**WIFI TRANSMITTER INTERFACE WITH ANDROID AND IOS.** Controller 16905.99 and driver 24Vdc to be ordered separately.

All control functions can be managed by an App available on the market for downloading (via App you can manage up to a maximum of 8 groups). While selecting the right driver, one should consider 10W needed to power the WiFi transmitter.

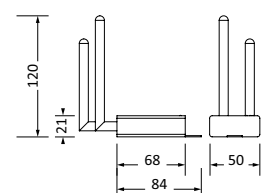
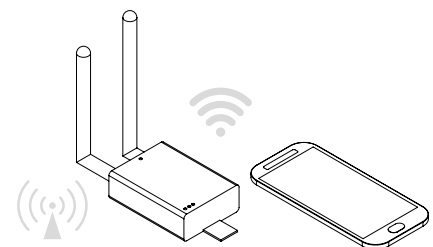

Codice/Code

**16904.99**

# FUNZIONAMENTO IN MODALITÀ WHITE - WHITE MODE

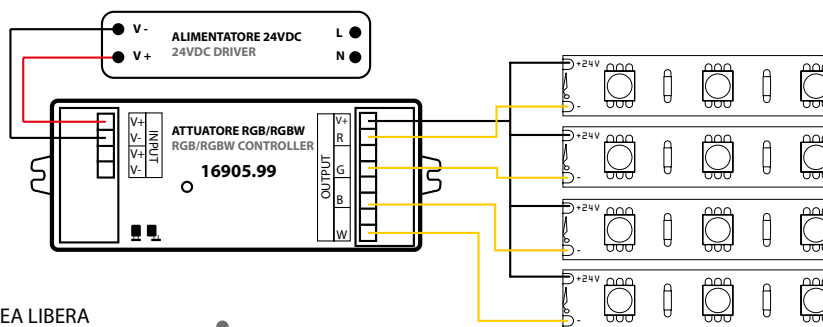
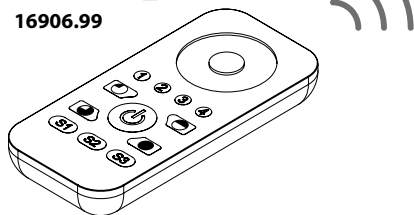

MAX 30m IN AREA LIBERA  
MAX 30m FREE FIELD

CARICO MAX / MAX LOAD  
(5A x 4CH)

STRIP LED WHITE	N° bobine per attuatore Nos.reels for each controller	Potenza Alimentatori Driver power W
14,4 W/m	4	320
	3	240/250
	2	150
16,5 W/m - 19,2 W/m	1	100
	3	320
21 W/m - 22 W/m	2	240/250
	1	100

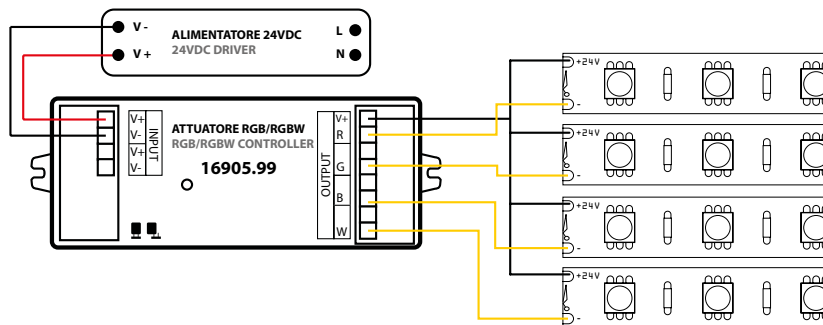

CARICO MAX / MAX LOAD  
(5A x 4CH)

# FUNZIONAMENTO IN MODALITÀ RGB-RGB+W - RGB-RGB+W MODE

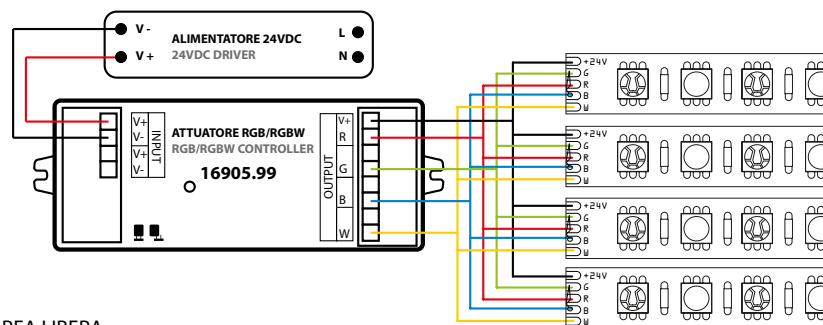
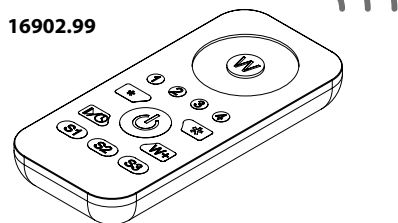

MAX 30m IN AREA LIBERA  
MAX 30m FREE FIELD

CARICO MAX / MAX LOAD  
(5A x 4CH)

STRIP LED RGB	N° bobine per attuatore Nos.reels for each controller	Potenza Alimentatori Driver power W
14,4 W/m	4	320
	3	240/250
	2	150
	1	100

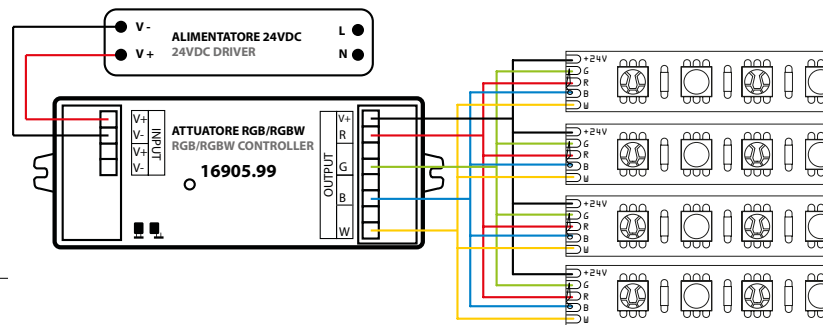

CARICO MAX / MAX LOAD  
(5A x 4CH)

STRIP LED RGB+W	N° bobine per attuatore Nos.reels for each controller	Potenza Alimentatori Driver power W
14,4 W/m (7,2 W/m RGB + 7,2 W/m White)	3	240/250
	2	150
	1	100



# FUNZIONAMENTO IN MODALITÀ RGB/RGB+WHITE CON AMPLIFICATORE DI SEGNALE

## - RGB/RGB+WHITE MODE WITH SIGNAL AMPLIFIER

**AMPLIFICATORE DI SEGNALE PER ATTUATORE 24V RGB/RGB+WHITE**, alimentatore 24Vdc e Kit di controllo per Strip LED da ordinare a parte. Massimo carico 5Ax4 canali.

**AMPLIFIER FOR 24V CONTROLLER RGB/RGB+WHITE**, driver 24Vdc and Control Kit for Strip LED to be ordered separately. Maximum load 5A x 4CH.

Codice/Code	L (mm)	A (mm)	H (mm)
<b>16908.99</b>	178	46	22

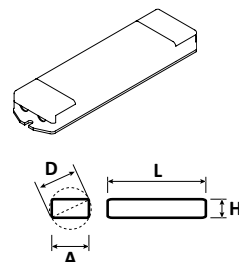

NB: UTILIZZARE IL COLLEGAMENTO TRAMITE AMPLIFICATORI PER DISTANZE SUPERIORI ALLA PORTATA DEL TELECOMANDO (30M IN ARIA LIBERA).

/ USE CONNECTION THROUGH AMPLIFIERS FOR DISTANCES GREATER THAN 30M FREE FIELD.

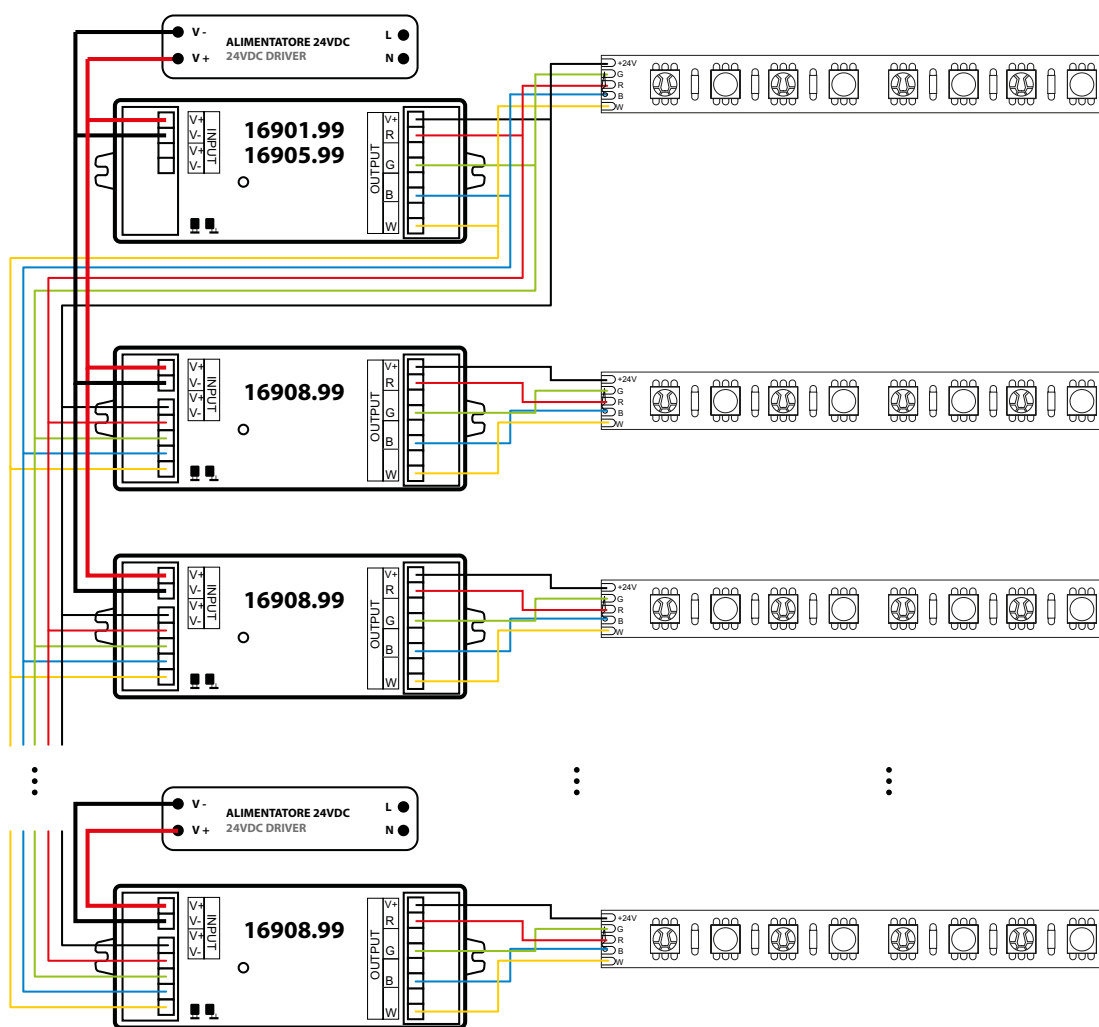

STRIP LED RGB	N° bobine per amplificatore Nos.reels for each amplifier	Potenza Alimentatori Driver power W	STRIP LED RGB+W	N° bobine per amplificatore Nos.reels for each amplifier	Potenza Alimentatori Driver power W
14,4 W/m	4	320	14,4 W/m	3	240/250
	3	240/250	(7,2 W/m RGB + 7,2 W/m White)	2	150
	2	150		1	100
	1	100			